

Appendix M

Plates

FILENAME: S:\BTE\BTE\Projects\2023\Proj\23-041 County of Essex County Rd 46 EA\005-Drawings\DWG\Preliminary Design\23-041 Preliminary Design Plates 2028-03-30.dwg
 FLORDATE: Mar 31, 2028 - 9:53am

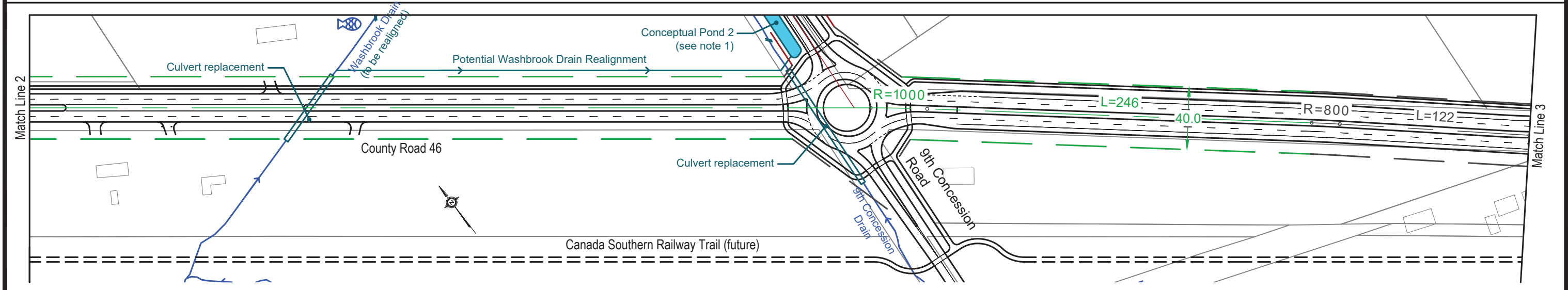
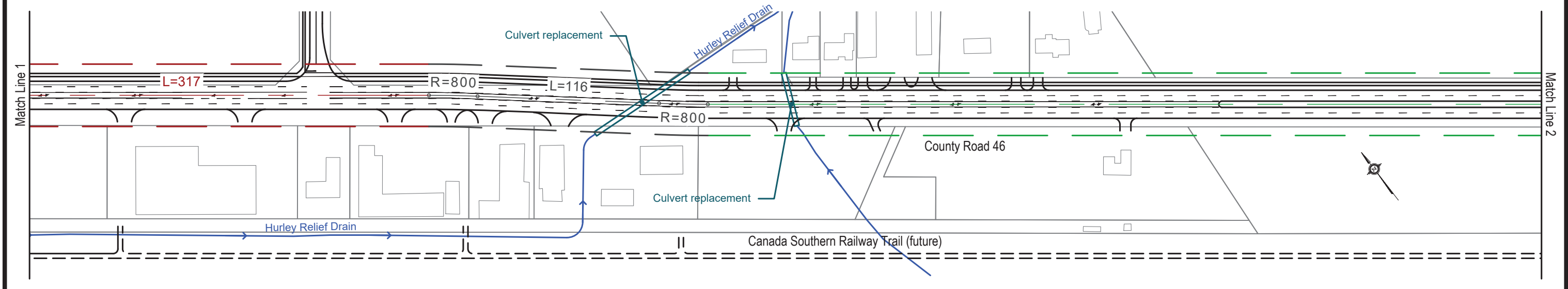
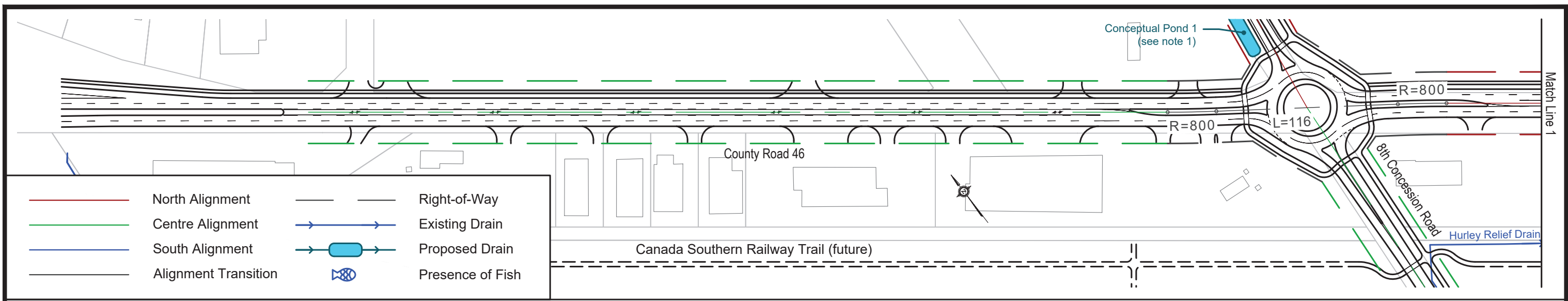

Note 1: Conceptual stormwater management facility location only illustrated and size and location to be considered further in detail design and consider any integration with land storm water requirements from integrated developments at the time of implementation. Property requirements to be determined by the future stormwater design.



SCALE	25 0 50 1:2500
DATE	March 31, 2026
DRAWN BY	D.R.
FILE No.	23-041

COUNTY OF ESSEX ROAD 46
Preliminary Technically Preferred Alternative Sections 1 and 2

PLATE
1

FILENAME: S:\BTE\BTE\Eng Projects\2023 Proj\23-041 County of Essex County Rd 46 EA\005-Drawings\DWG\Preliminary Design\23-041 Preliminary Design Plates 2028-03-30.dwg
 PLDATE: Mar 31, 2028 - 9:53am

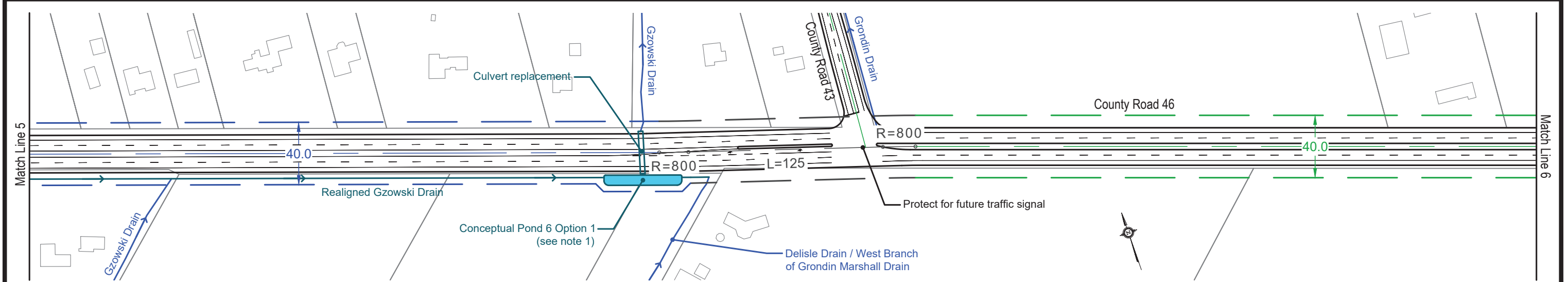
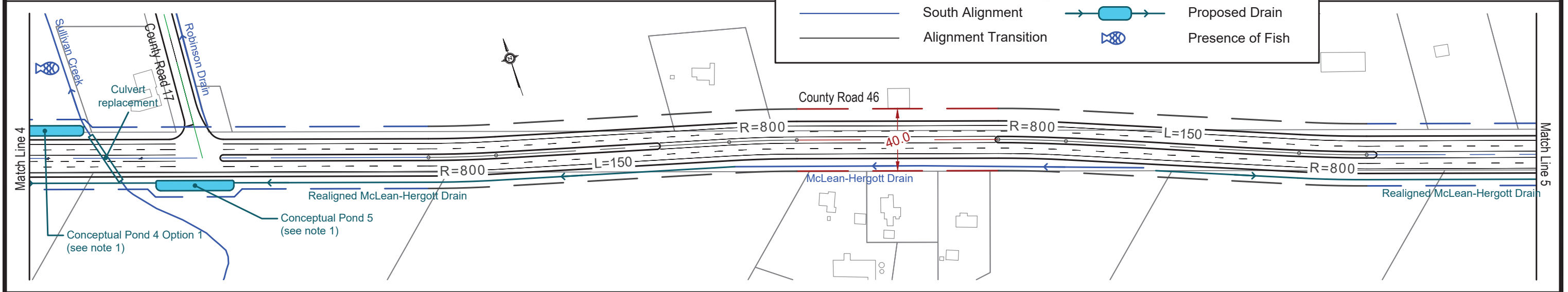
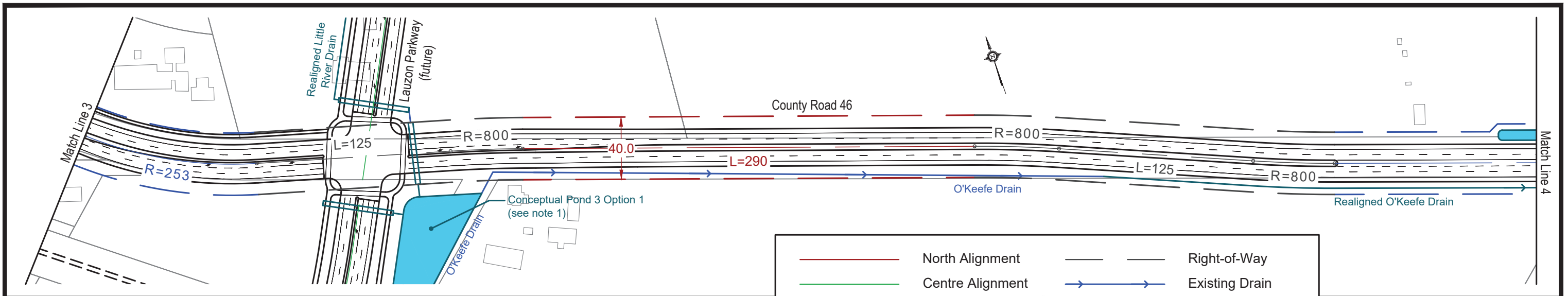

Note 1: Conceptual stormwater management facility location only illustrated and size and location to be considered further in detail design and consider any integration with land storm water requirements from integrated developments at the time of implementation. Property requirements to be determined by the future stormwater design.

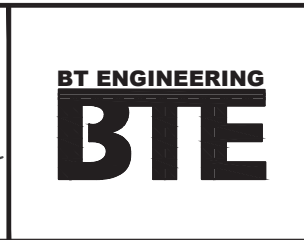

SCALE	25 0 50 1:2500
DATE	March 31, 2026
DRAWN BY	D.R.
FILE No.	23-041

COUNTY OF ESSEX ROAD 46
 Preliminary Technically Preferred Alternative
 Section 3 West

PLATE
 2

FILENAME: S:\BTE\BTE\Eng Projects\2023 Proj\23-041 County of Essex County Rd 46 EA\005-Drawings\DWG\Preliminary Design\23-041 Preliminary Design Plates 2028-03-30.dwg
 FLORDATE: Mar 31, 2028 - 9:53am

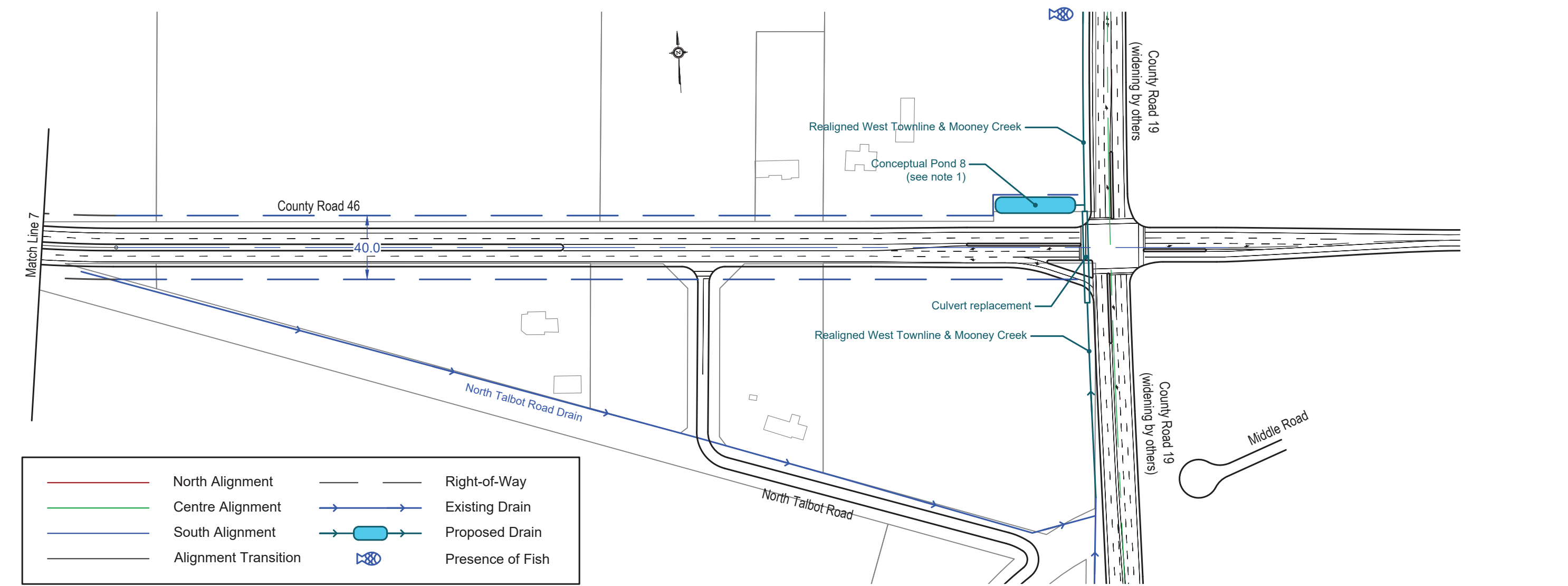
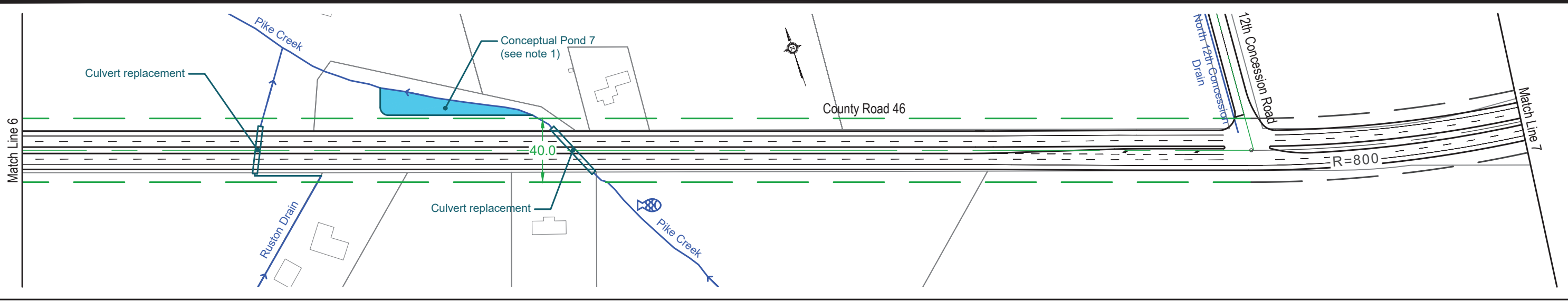

	North Alignment		Right-of-Way
	Centre Alignment		Existing Drain
	South Alignment		Proposed Drain
	Alignment Transition		Presence of Fish

Note 1: Conceptual stormwater management facility location only illustrated and size and location to be considered further in detail design and consider any integration with land storm water requirements from integrated developments at the time of implementation. Property requirements to be determined by the future stormwater design.



SCALE	
	1:2500
DATE	March 31, 2026
DRAWN BY	D.R.
FILE No.	23-041

COUNTY OF ESSEX ROAD 46
Preliminary Technically Preferred Alternative Section 3 East

PLATE
3

9th Concession Road (north)

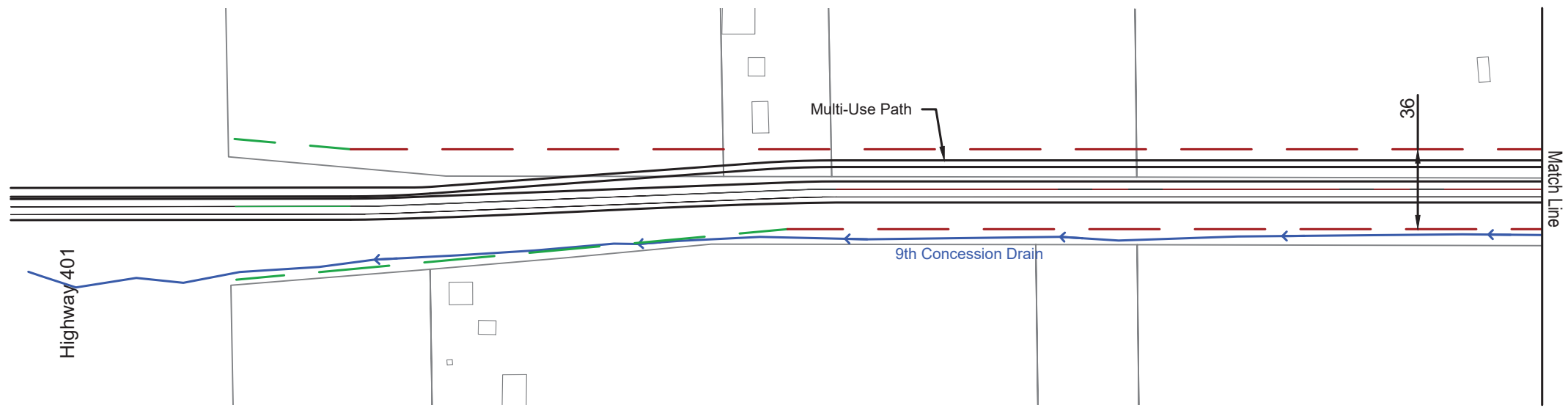

Note 1: Conceptual stormwater management facility location only illustrated and size and location to be considered further in detail design and consider any integration with land storm water requirements from integrated developments at the time of implementation. Property requirements to be determined by the future stormwater design.

9th Concession Road (south)

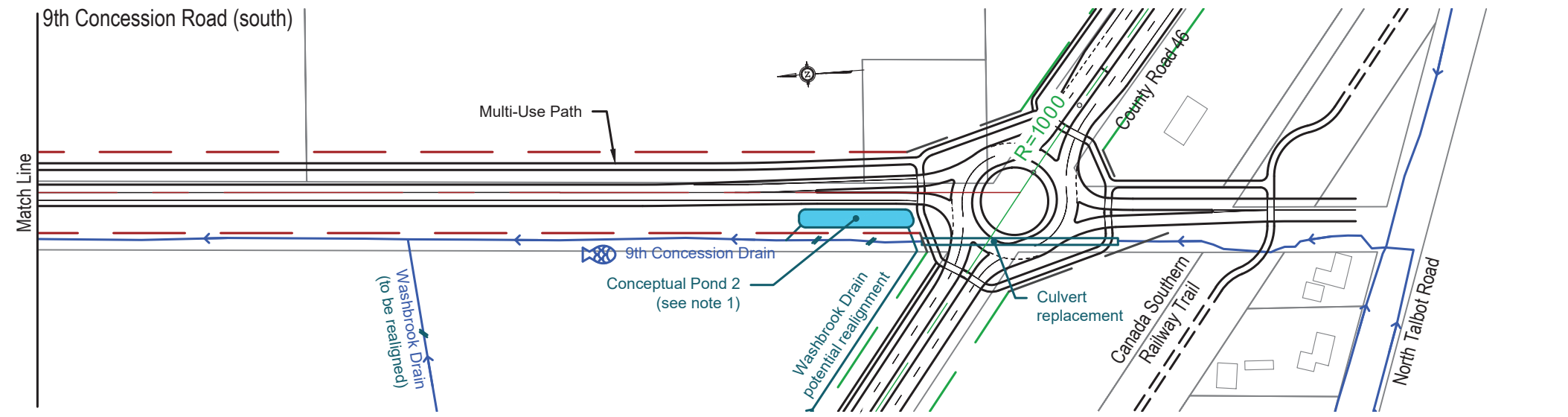
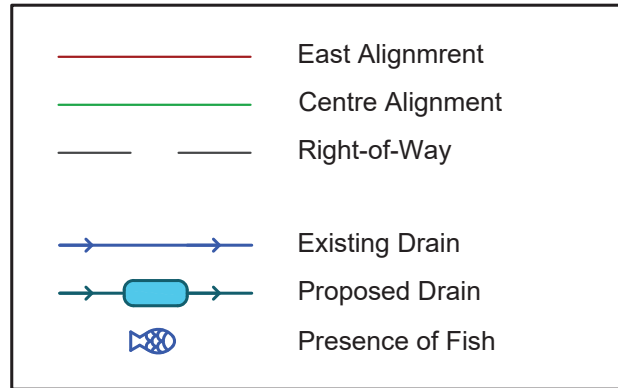

8th Concession Road

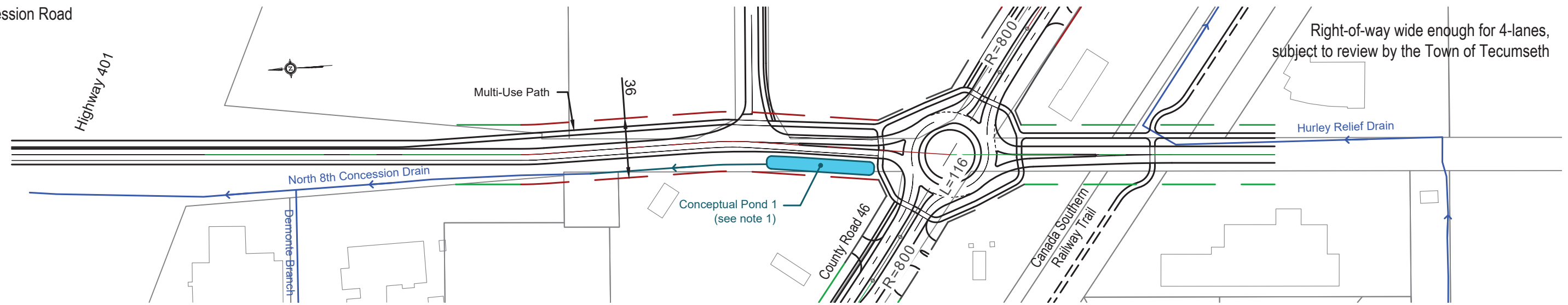

Right-of-way wide enough for 4-lanes, subject to review by the Town of Tecumseth

FILENAME: S:\BTE\BTE\Projects\2023 Pro\23-041 County of Essex County Rd 46 EA\005-Drawings\DWG\Preliminary Design\23-041 Preliminary Design Plates 2028-03-30.dwg
 PLDATE: Mar 31, 2028 - 9:53am



SCALE	25 0 50 1:2500
DATE	March 31, 2026
DRAWN BY	D.R.
FILE No.	23-041

COUNTY OF ESSEX ROAD 46
 Preliminary Technically Preferred Alternative
 8th and 9th Concession Roads

PLATE
 4

FILENAME: S:\SITE\BTE\Eng Projects\2023 Proj\23-041 County of Essex County Rd 46 EA\005-Drawings\DWG\Preliminary Design\23-041 Preliminary Design Plates 2028-03-30.dwg
 PLODATE: Mar 31, 2026 - 9:53am

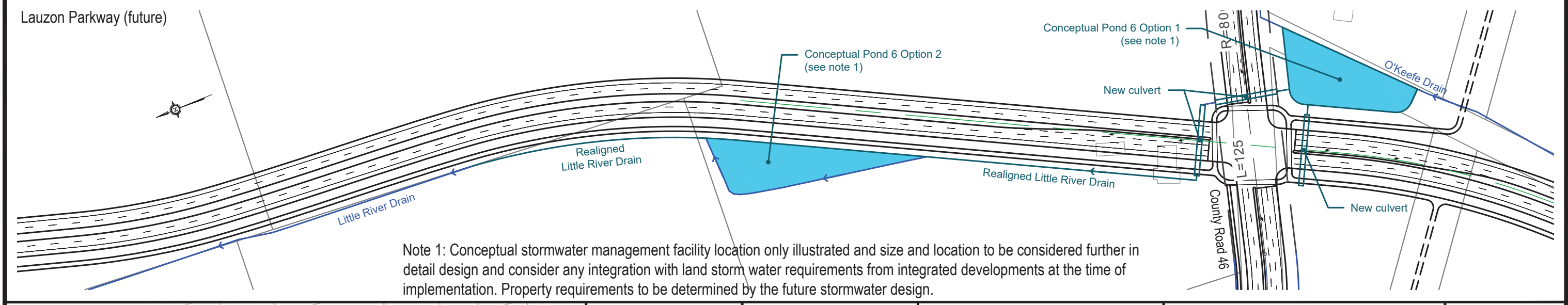
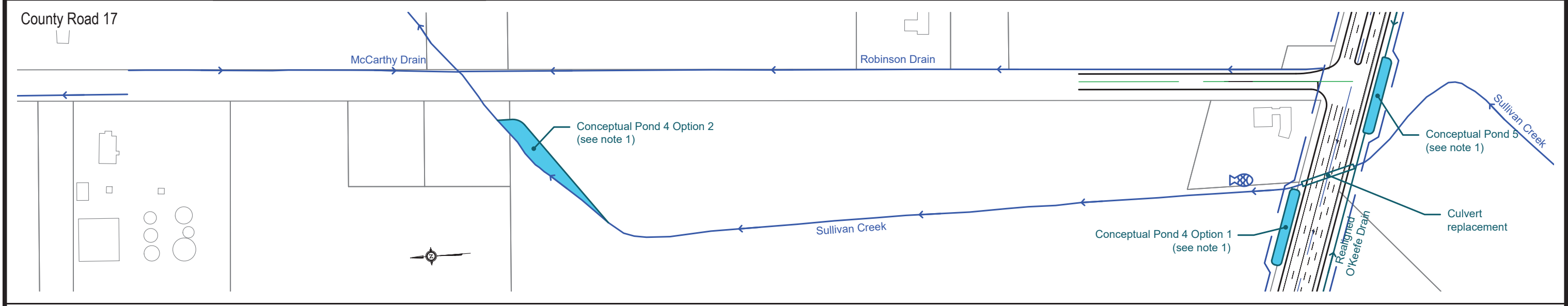
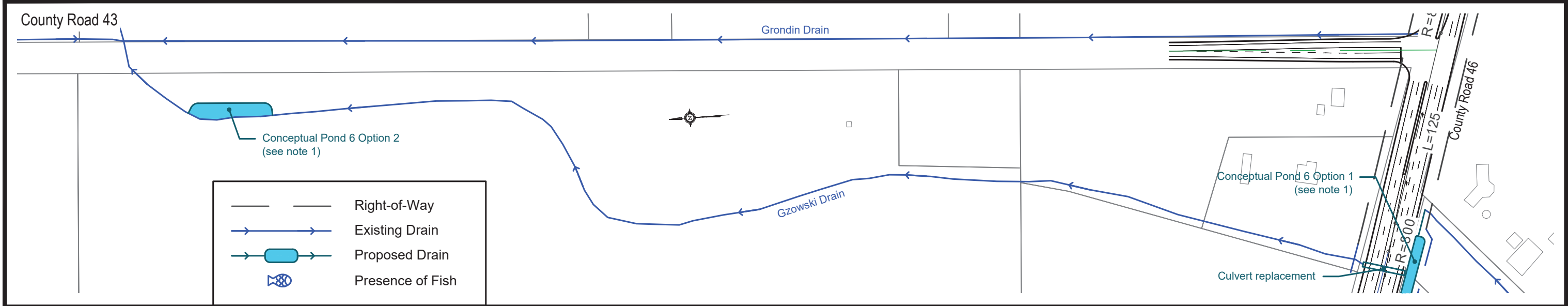

Note 1: Conceptual stormwater management facility location only illustrated and size and location to be considered further in detail design and consider any integration with land storm water requirements from integrated developments at the time of implementation. Property requirements to be determined by the future stormwater design.



SCALE	25 0 50 1:2500
DATE	March 31, 2026
DRAWN BY	D.R.
FILE No.	23-041

COUNTY OF ESSEX ROAD 46

Preliminary Technically Preferred Alternative
 Lauzon Parkway, County Roads 17 and 43

PLATE
 5